

# Repair Parts for Check-Mate<sup>®</sup> 100cc Displacement Pumps

312467H

EN

---

*With priming piston and Severe Duty<sup>®</sup> or MaxLife<sup>®</sup> rod and cylinder.*



**Important Safety Instructions**

Read all warnings and instructions in manual 312375. Save those instructions.



See manual 312375 for complete disassembly and reassembly instructions.

## Parts

Ref.	Part	Description	Qty.	Ref.	Part	Description	Qty.
1	★**255569	KIT, rod, displacement; chrome (includes 18, 21)	1	24‡	★**187858	ROD, piston; chrome	1
	26A464	ROD only; chrome	1	‡	‡26A463	ROD, piston; MaxLife	
	‡255570	KIT, rod, displacement; MaxLife (includes 18, 21)	1	25	★‡184122	GUIDE, piston; cs	1
	24A461	ROD only; MaxLife	1		‡15U598	GUIDE, piston; sst	1
2	★‡255604	KIT, housing, outlet, (150 mm) (includes 18, 21, 44, 47, 49, 52)	1	26	★‡184051	PISTON; cs	1
	★‡25C877	HOUSING only	1		‡15U597	PISTON; sst	1
	‡257561	KIT, housing, outlet, (150 mm); sst (includes 18, 21, 44, 47, 49, 52)	1	27	★‡184121	NUT, shovel; cs	1
	‡25C878	HOUSING only	1		‡15U596	NUT, shovel; sst	1
3	★‡15K751	CARTRIDGE	1	28	★‡15M518	GUIDE, piston; cs	1
	‡15U603	CARTRIDGE; sst	1		‡257667	GUIDE, piston; sst	1
4‡	104361	O-RING, cartridge	1	29‡	26A467	BEARING, guide	1
5‡	★*	GLAND, packing female; see <b>Packing Kits</b> on page 6	1	30	★‡184052	SEAT, piston; cs	1
	‡*	GLAND, packing, u-cup; see <b>Packing Kits</b> on page 6	1		‡15U591	SEAT, piston; ss	1
6‡	★*	V-PACKING; UHMWPE; see <b>Packing Kits</b> on page 6	3	31‡	184053	SEAL, piston	1
	‡*	SPACER, u-cup; see <b>Packing Kits</b> on page 6	1	32	★‡15M485	VALVE, intake; cs	1
7‡	★*	V-PACKING; PTFE; see <b>Packing Kits</b> on page 6	2		‡26A475	VALVE, intake; ss	1
	‡*	SPACER, u-cup; acetal; see <b>Packing Kits</b> on page 6	1	33	15M484	NUT, packing; cs	1
8‡	★*	GLAND, packing male; see <b>Packing Kits</b> on page 6	1		‡15U599	NUT, packing; ss	1
9‡	★*	NUT, packing, open wet cup	1	34‡		GLAND, male, piston; see <b>Packing Kits</b> on page 6	1
	‡15U974	CUP, wet, enclosed; sm	1	35‡		PACKING, UHMWPE; see <b>Packing Kits</b> on page 6	2
	‡25C969	CUP, wet, enclosed; cm	1		‡*	PACKING; leather; see <b>Packing Kits</b> on page 6	2
10‡	‡15U975	COVER, wet cup; sm	1		★*	PACKING, PTFE; see <b>Packing Kits</b> on page 6	2
	‡25C970	COVER, wet cup; cm	1	37‡		GLAND, female, piston; see <b>Packing Kits</b> on page 6	1
11‡	‡161446	O-RING	1	38‡	184469	SEAL, valve	1
12‡	‡26A458	SIGHTGLASS	1	39	190126	HOUSING, valve; cs	1
13‡	‡102228	COVER, oil hole	1		‡184392	HOUSING, valve; ss	1
14‡	‡117026	SCREW, socket hd cap; M5 x 12	3	40	190128	PLUG, valve; cs	1
15‡	‡121129	WIPER, wet cup cover	1		‡190293	PLUG, valve; ss	1
16‡	‡121125	SEAL, wet cup cover	1	41‡	121133	HANDLE, outlet bleed	1
17‡	★**26A470	CYLINDER, pump, 100 cc; ss	1	42‡	121134	CLIP, outlet bleed	1
	★**15V122	CYLINDER, pump, 60 cc; ss	1	43	★‡184037	FITTING, outlet; cs	1
	‡26A462	CYLINDER, pump, MaxLife, 100 cc	1		‡15U592	FITTING, outlet; sst	1
	26A472	CYLINDER, pump, MaxLife, 60 cc	1	44‡	110135	O-RING	1
18‡	109205	O-RING	2	47▲	184090	LABEL, warning	1
19	★‡184044	HOUSING, valve; cs	1	48▲	184151	LABEL, warning	1
	‡15U586	HOUSING, valve; sst	1	49	100508	SCREW, drive	7
20‡	‡15U604	SEAT, intake; sst	1	50▲	172479	TAG, instruction, safety	1
	★‡184617	SEAT, intake; cs	1	51‡	‡110208	PLUG, pipe; ss	1
21‡	187860	SEAL	1	52‡	197561	PLATE, identification	1
22	★‡255610	KIT, intake housing, cylinder; cs (includes 21, 48, 49)	1	61	‡26A471	RING, retaining	1
	‡257560	KIT, intake housing, cylinder; sst (includes 21, 48, 49)	1				
23‡	‡15U590	SEAT, piston; sst	1				
	★‡184042	SEAT, piston; cs	1				

★ *Model L100CS only.*\* *Model L100SS only*‡ *Model L100CM only.*\* *Model L100SM only.*‡ *See table.*▲ *Replacement Danger and Warning labels, tags, and cards are available at no cost.*

**KEY:**

Torque to 85-95 ft-lb (115-128 N•m)

Torque to 28-44 ft-lb (38-59 N•m)

Torque to 213-287 ft-lb (288-387 N•m)

Torque to 43-47 ft-lb (58-63 N•m)

Torque to 34-38 ft-lb (45-51 N•m)

Torque to 26-30 ft-lb (35-41 N•m)

Torque to 90-130 ft-lb (122-173 N•m)

Torque to 44-62 ft-lb (60-84 N•m)

Apply thread sealant

L: Piston Check Valve Assembly (includes 23)

M: Throat Packings

N: Intake Valve Packings

Lubricate all soft seal components before installation.

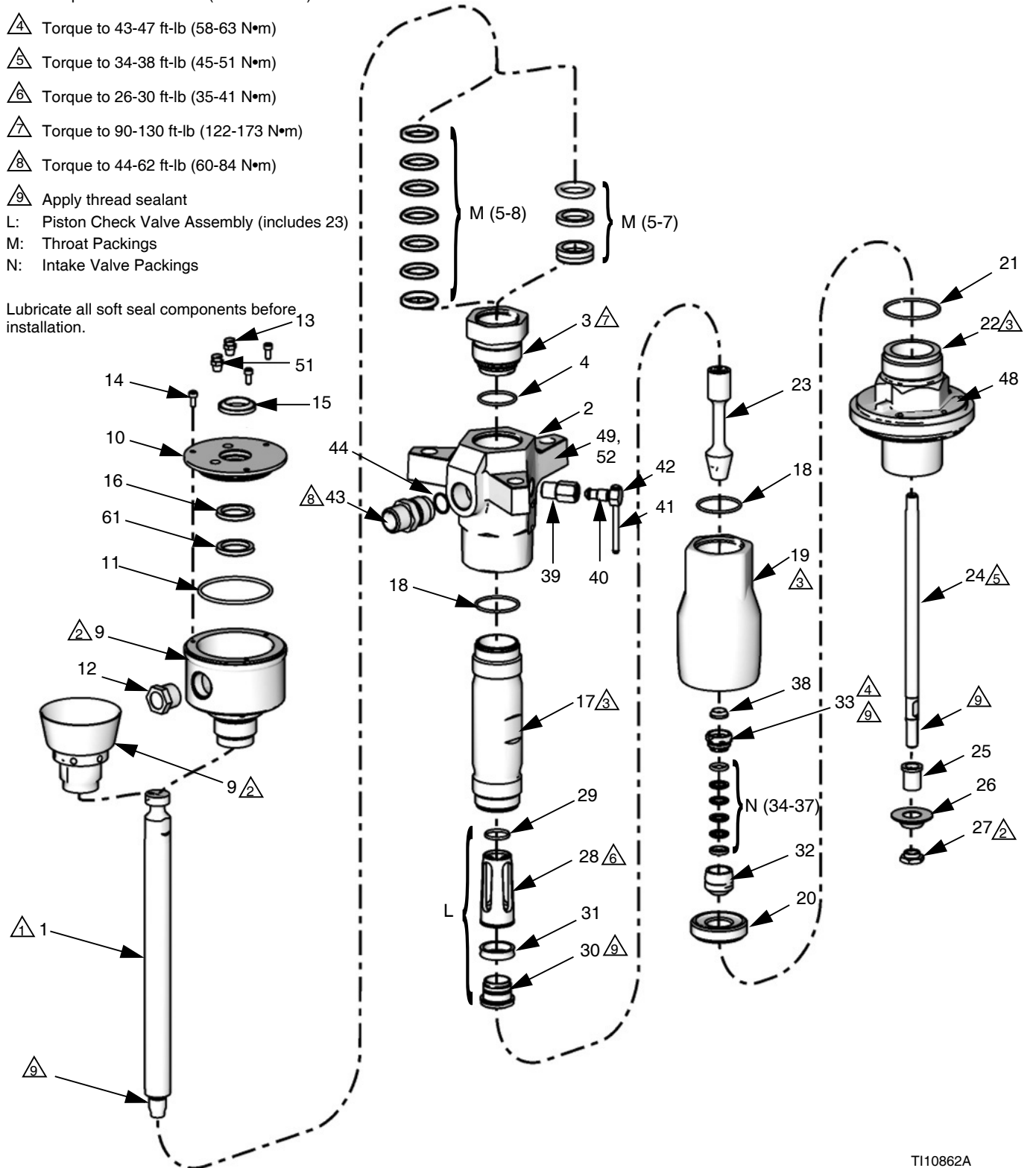

TI10862A

# Kits

The following table indicates which parts (according to reference number) are included in each kit.

Kit	Reference Numbers																																																												
	4	5	6	7	8	9	10	11	12	13	14	15	16	17	18	20	21	23	24	29	30	31	32	33	34	35	36	37	38	39	40	41	42	44	51	61																									
255507	✓	✓	✓	✓	✓										✓		✓			✓		✓				✓	✓	✓	✓	✓																		✓													
256866	✓	✓	✓	✓	✓										✓		✓			✓		✓					✓	✓	✓	✓	✓																			✓											
255508	✓	✓	✓	✓					✓				✓	✓	✓		✓			✓		✓					✓	✓	✓	✓	✓																		✓	✓											
256867	✓	✓	✓	✓					✓				✓	✓	✓		✓			✓		✓					✓	✓	✓	✓	✓																		✓	✓											
255523	✓	✓	✓	✓	✓																																																								
255524	✓	✓	✓	✓					✓				✓	✓																																						✓									
257558	✓	✓	✓	✓					✓				✓	✓																																						✓									
255533															✓		✓			✓		✓																																							
255539																	✓										✓	✓	✓	✓	✓																														
256865																	✓										✓	✓	✓	✓	✓																														
255540																	✓										✓	✓	✓	✓	✓																														
256868																	✓										✓	✓	✓	✓	✓																														
255551															✓		✓	✓			✓	✓	✓																																						
257557															✓		✓	✓			✓	✓	✓																																						
255557																✓	✓							✓	✓	✓	✓	✓	✓	✓	✓																														
256869																✓	✓							✓	✓	✓	✓	✓	✓	✓	✓																														
255558																✓	✓							✓	✓	✓	✓	✓	✓	✓	✓																														
256870																✓	✓							✓	✓	✓	✓	✓	✓	✓	✓																														
255577															✓		✓		✓								✓	✓	✓	✓	✓	✓																													
256871															✓		✓		✓								✓	✓	✓	✓	✓																														
255578															✓		✓		✓								✓	✓	✓	✓	✓																														
256872															✓		✓		✓								✓	✓	✓	✓	✓																														
255591															✓	✓		✓			✓		✓																																						
255592															✓	✓		✓			✓		✓																																						
237908																																																				✓	✓	✓	✓						
255616																																																					✓	✓	✓	✓					
255618													✓																																										✓						
255696	✓	✓	✓	✓			✓	✓	✓	✓	✓	✓	✓	✓																																					✓	✓									
257559	✓	✓	✓	✓			✓	✓	✓	✓	✓	✓	✓	✓																																						✓	✓								
16F205	✓	✓	✓		✓										✓		✓							✓			✓	✓		✓	✓																			✓											

**Kit Descriptions**

<b>Kit</b>	<b>Description</b>
255507	Complete Seal Kit; Severe Duty, L100CS
256866	Complete Seal Kit; Severe Duty, L100SS
255508	Complete Seal Kit; MaxLife, L100CM
256867	Complete Seal Kit; MaxLife, L100SM
16F205	Complete Seal Kit; PTFE Alternative; includes all PTFE Alternative kits listed under <b>Packing Kits</b> , page 6
255523	Throat Seal Kit; Severe Duty
255524	Throat Seal Kit; MaxLife, L100CM
257558	Throat Seal Kit; MaxLife, L100SM
255533	Piston Seal Kit
255539	Intake Kit; Severe Duty, L100CS
256865	Intake Kit; Severe Duty, L100SS
255540	Intake Kit; MaxLife, L100CM
256868	Intake Kit; MaxLife, L100SM
255551	Piston Seal Metal and Soft Kit CS and CM
257557	Piston Seal Metal and Soft Kit SS and SM
255557	Intake Valve Seal Metal and Soft Kit; Severe Duty, L100CS
256869	Intake Valve Seal Metal and Soft Kit; Severe Duty; L100SS
255558	Intake Valve Seal Metal and Soft Kit; MaxLife, L100CM
256870	Intake Valve Seal Metal and Soft Kit; MaxLife, L100SM
255569	Displacement Rod Kit; Severe Duty; see page 2 for parts included in kit
255570	Displacement Rod Kit; MaxLife; see page 2 for parts included in kit
255577	Priming Piston Rod Kit; Severe Duty, L100 CS
256871	Priming Piston Rod Kit; Severe Duty, L100 SS
255578	Priming Piston Rod Kit; MaxLife, L100CM
256872	Priming Piston Rod Kit; MaxLife, L100SM
255591	Cylinder Kit; L100SS and L100SM
255592	Cylinder Kit; L100CS and L100CM
255604	Outlet Kit, L100CS; see page 2 for parts included in kit
257561	Outlet Kit, L100SS; see page 2 for parts included in kit

<b>Kit</b>	<b>Description</b>
255610	Intake Cylinder Kit, L100CS; see page 2 for parts included in kit
257560	Intake Cylinder Kit, L100SS; see page 2 for parts included in kit
237908	Bleed Valve Kit; CS
255616	Bleed Valve Kit; SS
255618	Enclosed Wet Cup Seal Kit; MaxLife
255696	Enclosed Wet Cup Kit; MaxLife
257559	Enclosed Wet Cup Kit; MaxLife, SS

# Packing Kits

## Throat Packings

### Severe Duty

Ref.	Part	Description	Qty.
5	★⊠	184172 GLAND, packing female; sst	1
	✱✱	184172 GLAND, packing, female; sst	1
6		109252 V-PACKING; UHMWPE	3
7		109302 V-PACKING; PTFE	2
8	★⊠	184222 GLAND, packing male; sst	1
	✱✱	184222 GLAND, packing male; sst	1

### MaxLife

Ref.	Part	Description	Qty.
5		121100 SEAL, u-cup	1
6	★⊠	15V120 SPACER, cs	1
	✱✱	15M488 SPACER, sst	1
7		26A469 SPACER, acetal	1

### Severe Duty

\* Lips face down

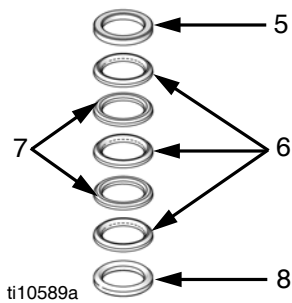

### MaxLife

\* Lips face down

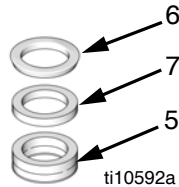

### PTFE Alternative

Ref.	Part	Description	Qty.
5		184172 GLAND, packing, female; sst	1
6		109302 V-PACKING, PTFE	5
8		184222 GLAND, packing, male; sst	1

\* Lips face down

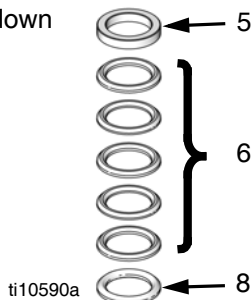

# Intake Valve Packings

## Severe Duty and MaxLife

Ref.	Part	Description	Qty.
34	★⊠	26A465 GLAND, male, priming piston; cs	1
	✱✱	26A474 GLAND, male, priming piston; sst	1
35	✱✱	26A460 PACKING; UHMWPE	2
36	★*	26A468 PACKING; PTFE	2
	⊠✱	26A459 PACKING; leather	2
37	★⊠	26A466 GLAND, female, priming piston; cs	1
	✱✱	26A473 GLAND, female, priming piston; sst	1

★ Model L100CS only.

\* Model L100SS only.

⊠ Model L100CM only.

✱ Model L100SM only.

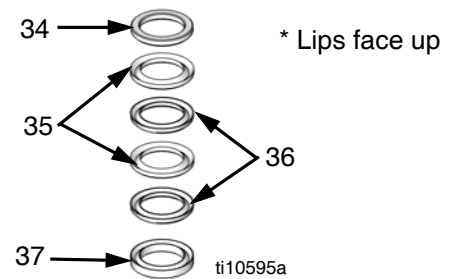

### PTFE Alternative

Ref.	Part	Description	Qty.
34		26A474 GLAND, male, priming piston; sst	1
35		26A468 PACKING, PTFE	4
37		26A473 GLAND, female, priming piston; sst	1

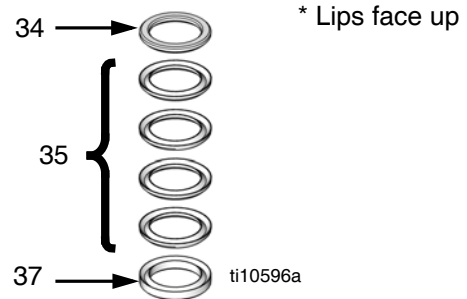

## Piston Packings

### PTFE Alternative

Ref.	Part	Description	Qty.
31		184053 SEAL, piston	1

All written and visual data contained in this document reflects the latest product information available at the time of publication. Graco reserves the right to make changes at any time without notice.

Original instructions. This manual contains English. MM 312467

Graco Headquarters: Minneapolis

International Offices: Belgium, China, Japan, Korea

GRACO INC. AND SUBSIDIARIES • P.O. BOX 1441 • MINNEAPOLIS MN 55440-1441 • USA

Copyright 2007, Graco Inc. All Graco manufacturing locations are registered to ISO 9001.

www.graco.com

Revision H, July 2021