

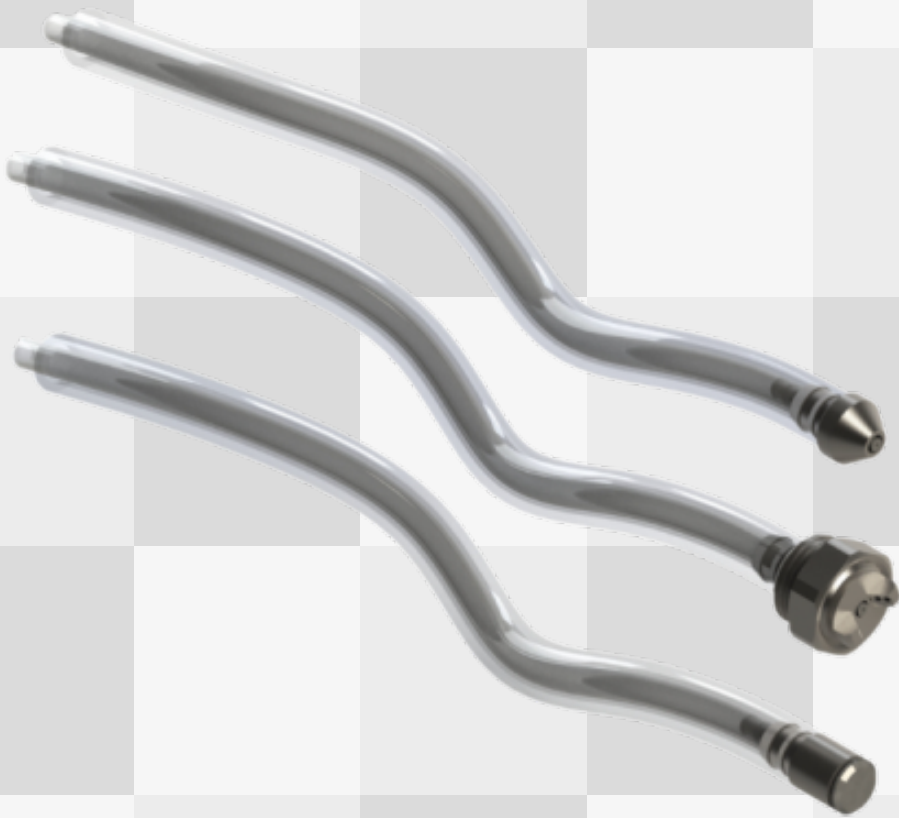

SPRAYNOZZLE, SD-K

schütze
SPRAYTECHNOLOGY



ALFRED SCHÜTZE Apparatebau GmbH

www.schuetze-gmbh.de

Zeppelinstraße 2
28844 Weyhe-Dreye
Germany

Phone: 0049 (0) 421 / 43510-0
Fax: 0049 (0) 421 / 43510-43
Mail: info@schuetze-gmbh.de

Doc-ID
00021423



1 Description

The SCHÜTZE SPRAYNOZZLE SD-K is designed specially to apply sprayable fluids at hard to reach places.

By combining the hose for atomizing air and material into one hose you get the possibility to reach places a standard nozzle extension couldn't reach, thanks to the flexibility of the hose.

While using a connection adapter, the SD-K can be directly mounted onto a Schütze spray valve.

If using a hose adapter, two hoses can be combined to get the "hose-in-hose" connection.

Depending on the application, the SD-K can be fitted on different hose sizes and is also available in different nozzle sizes.

special designs on request
technical alterations reserved
for further information please contact us



2 Overview

2.1 SD-K

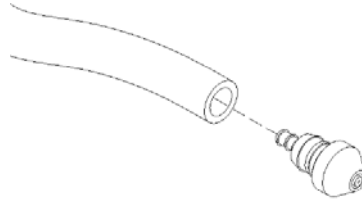
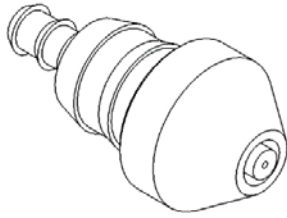

Spraynozzle, SD-K
200041

available nozzle diameters:
0.1 / 0.3 / 0.8 / 1.0 / 1.1

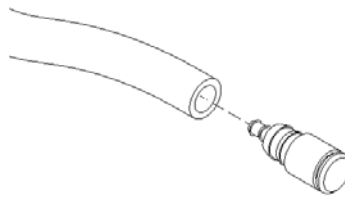
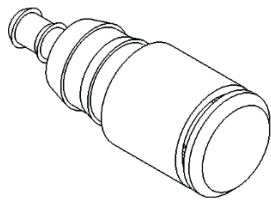

Spraynozzle, SD-K
circular spray (360°)
200041

available nozzle diameters:
12x0.4

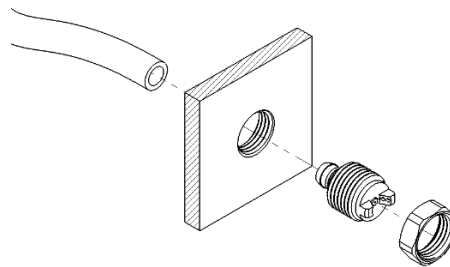
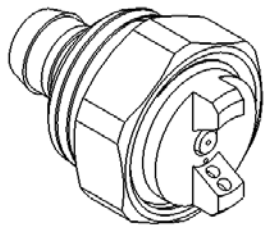

Spray Nozzle, SD-K-F
200517

available nozzle diameters:
0.3

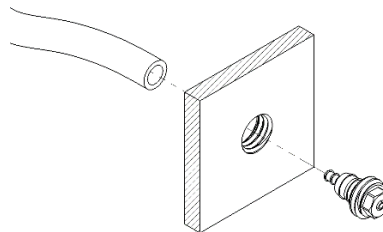
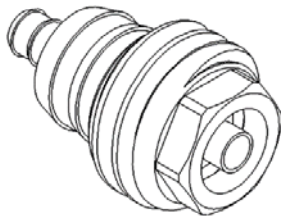

Spray Nozzle, SD-K AG
200397

available nozzle diameters:
0.2 / 0.3 / 1.0 / 2.0

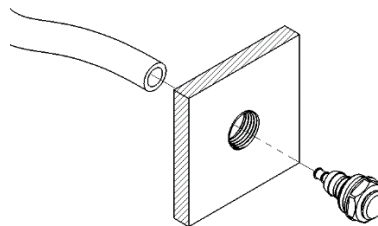
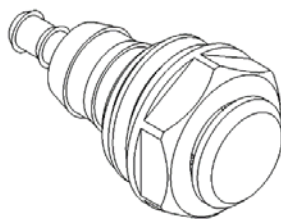

Spray Nozzle, SD-K AG
circular spray (360°)
200397

available nozzle diameters:
12x0.4

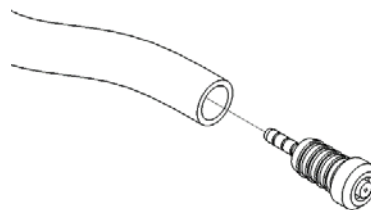
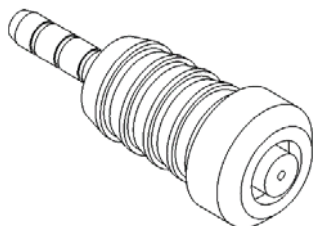

Spray Nozzle, SD-K-4
211088

available nozzle diameters:
0.3



2.2 SD-K with ball head

The SD-K with ball head can be tilted up to 30° and rotated for 360°.

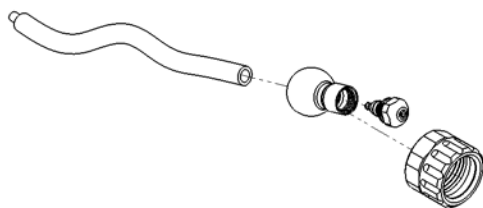
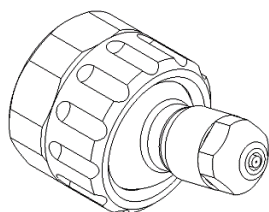

Spray Nozzle, SD-K-K 200597

Contains a nozzle holder with ball head, Collar ring and a SD-K AG (M8x0.75)

2.3 Adapters

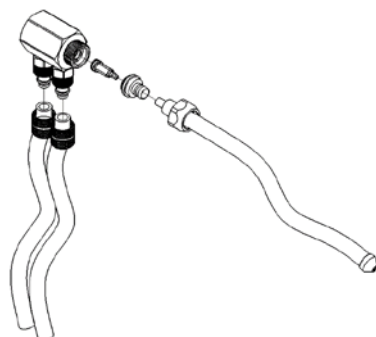
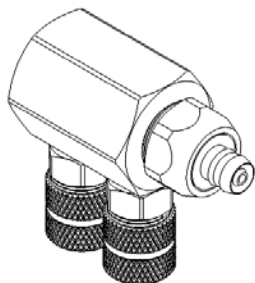

Hose adapter for SD-K 340078

Used for combining the hoses for atomizing air and material into the "hose-in-hose" connection

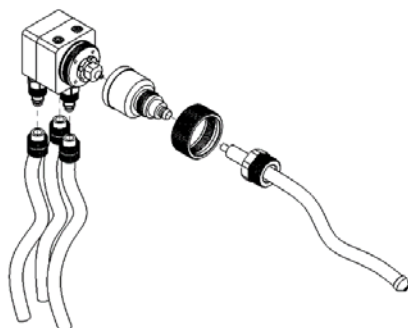
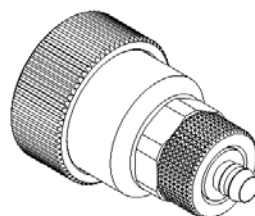

Connection adapter for SD-K 310476

Used for mounting directly onto a Schütze spray valve (i.e. KA-2) to get the "hose-in-hose" connection

2.4 Hose sizes

Hose-ø	ø4/3 + ø2/1 (340147 + 340148) ¹	ø6/4 + ø3/2 (340007 + 340193) ²	ø8/6 + ø4/2.5 (340047 + 340064) ²
Part number			
200041	x	✓	x
200517	x	✓	x
200397	x	✓	✓ (M10)
211088	✓	x	x
200597	x	✓	x
340078	x	✓	x
310476	x	✓	x

→ Part numbers of the hoses correspond to ¹=PTFE / ²=PU - Other materials on request



3 Spray patterns

Depending on the used version, different spray patterns are available.

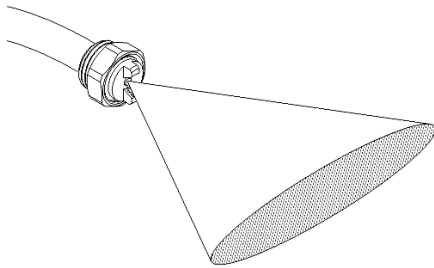

flat spray 60°

available as:
SD-K-F

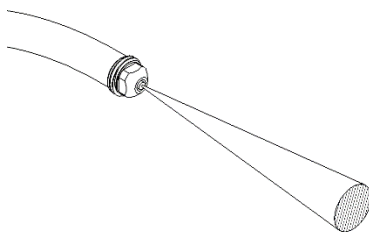
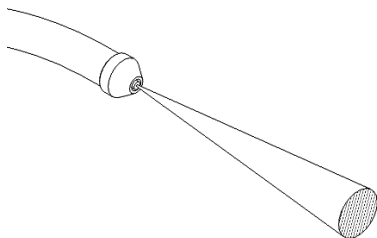
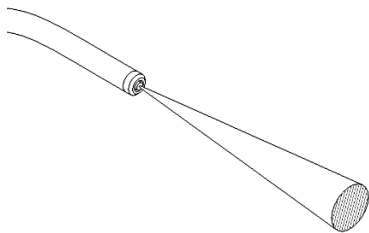

round spray 10°

available as:
SD-K
SD-K-AG
SD-K-4

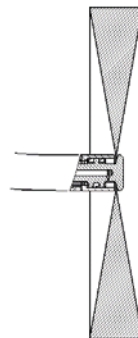
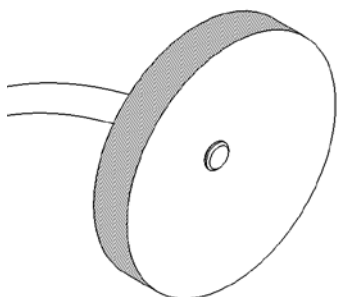

circular spray (360°)

for coating the inside of
cylindrical hollow bodies
like pipes

available as:
SD-K
SD-K-AG